

# FIXED PULVERIZER RFP100

IT



MADE IN ITALY <

EXCELLENT FOR SECONDARY DEMOLITION <

HARDOX WEAR-RESISTANT PARTS <

INTERCHANGEABLE TEETH, BLADES <

& PLATE

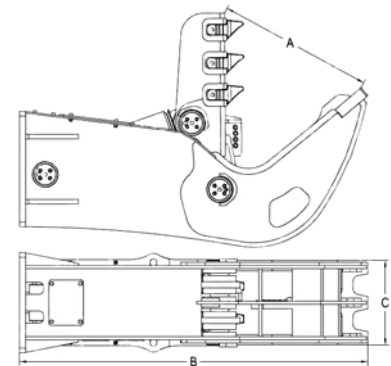

MATCH IT WITH



## DATA SHEET

	EU	USA
<b>Excavator weight</b>	80 - 130 t	80 - 130 t
<b>Equipment weight</b>	10400 kg	22928 lb
<b>Opening A</b>	1800 mm	71 inch
<b>Length B</b>	3200 mm	126 inch
<b>Width C</b>	950 mm	37,4 inch
<b>Maximum oil pressure</b>	340 bar	4930 psi
<b>Required oil supply</b>	500 - 600 L/min	132 - 158 gal/min

www.ramtec.it | info@ramtec.it |  +39 3499813724 | +39 0803388199



Data and pictures are not binding. The manufacturer can improve attachments without notice.