

FIXED PULVERIZER RFP20

IT



MADE IN ITALY <

EXCELLENT FOR SECONDARY DEMOLITION <

HARDOX WEAR-RESISTANT PARTS <

INTERCHANGEABLE TEETH, BLADES <

& PLATE

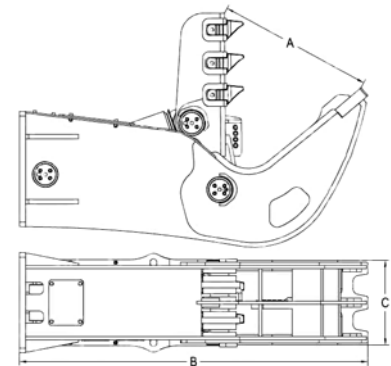

MATCH IT WITH



DATA SHEET

	EU	USA
Excavator weight	21 - 29 t	21 - 29 t
Equipment weight	2050 kg	4520 lb
Opening A	850 mm	34 inch
Length B	2300 mm	91 inch
Width C	550 mm	21,65 inch
Maximum oil pressure	340 bar	4930 psi
Required oil supply	220 - 300 L/min	58 - 79 gal/min

www.ramtec.it | info@ramtec.it |  +39 3499813724 | +39 0803388199



Data and pictures are not binding. The manufacturer can improve attachments without notice.